

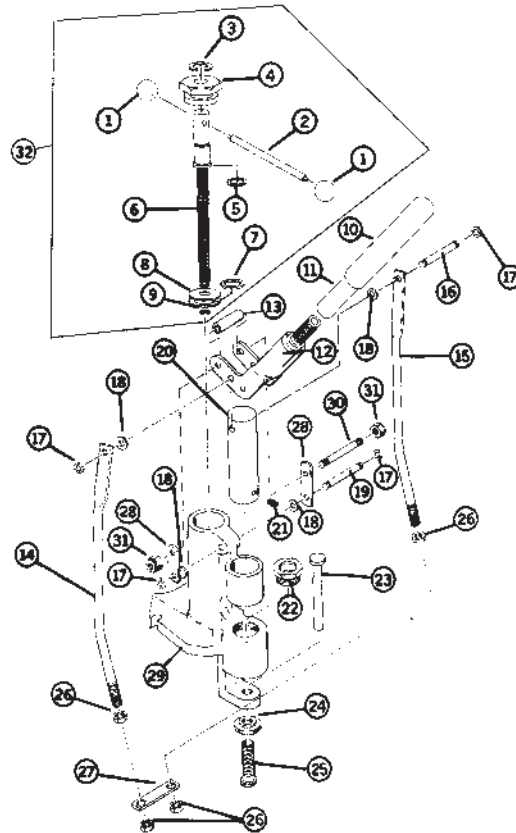

80040 LUBE-A-MATIC-2

| Key | Part # | Description |
|-----|--------|---------------------------------|
| 1 | 80054 | Handle knob (2) |
| 2 | 80053 | Lube Pressure Handle |
| 3 | 09105 | Retaining Ring |
| 4 | 80048 | Threaded Reservoir Cap |
| 5 | 80055 | Fiber Washer |
| 6 | 80042 | Lube Pressure screw |
| 7 | 80051 | O-Ring |
| 8 | 80047 | Lube Plunger |
| 9 | 80052 | Retaining Ring |
| 10 | 09264 | Handle Grip |
| 11 | 80064 | Metal Handle |
| 12 | 80067 | Handle Yoke Assembly |
| 13 | 80068 | Handle Yoke Spacer |
| 14 | 80079 | Linkage Arm, Left |
| 15 | 80080 | Linkage Arm, Right |
| 16 | 80057 | Ram Link Pin |
| 17 | 80056 | Retaining Ring, IRR 1000-25 (4) |
| 18 | 80072 | Handle Link Washer (4) |
| 19 | 80058 | Handle Link Pin |
| 20 | 80043 | Ram |
| 21 | 09099 | Setscrew 10/32 x 1/4 Flat Point |
| 22 | 80045 | Die Locking Cap |
| 23 | 80085 | Bullet Ejector Rod |
| 24 | 80049 | Bullet Ejector Rod Lock Ring |
| 25 | 80044 | Bullet Ejector Screw |
| 26 | 80081 | Jam Nut 5/16 x 18 (4) |
| 27 | 80082 | Bullet Ejector Plate |
| 28 | 80073 | Handle Link (2) |
| 29 | ◆ | Main Body Casting |
| 30 | 80070 | Handle Link Bolt |
| 31 | 80071 | Tri-Lock Nut 1/4 - 20 (2) |
| 32 | 80046 | Lube Pressure Screw Assembly |
| ❖ | 80099 | Die Locking Cap Wrench |



◆ Not Available Separately
❖ Not shown

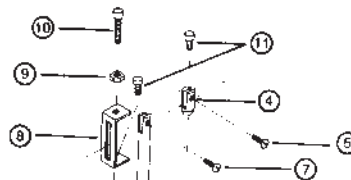

81100 PRO-MELT

| Key | Part # | Description |
|-----|--------|----------------------------------|
| 1 | ◆ | Furnace Body |
| 2 | 81103 | Base |
| 3 | 81104 | Handle |
| 4 | 81107 | Handle Fulcrum |
| 5 | 81108 | Pan Head Screw 5/40 x 1/2 |
| 6 | 81114 | Nozzle Shut-off Pin |
| 7 | 81115 | Pan Head Screw 5/40 x 3/8 |
| 8 | 81110 | Adjustment Bracket |
| 9 | 09603 | Hex Nut 10/32 |
| 10 | 81111 | SHCS 10/32 x 1/4 FP |
| 11 | 81109 | SHCS 10/32 x 3/8 |
| 12 | 81116 | Mould Guide Rod |
| 13 | 81117 | Mould Guide Collar (2) |
| 14 | 09099 | Hex Head Setscrew 10/32 x 1/4 FP |
| 15 | 81118 | Mould Guide Housing Bushing |

◆ Not Available Separately

